

Round Straight Aluminum

CATALOG NUMBER	WALL	SHAFT SIZE B	HT. H	BASE PLATE		BOLT CIRCLE	ANCHOR BOLTS	EPA 100 MPH	SHIP WT.
	A			D	E				
RSA-11-308	.125"	3"OD	8'	7"	1/2"	7"	3/4x16x3	3.0	14#
RSA-11-310	.125"	3"OD	10'	7"	1/2"	7"	3/4x16x3	2.2	16#
RSA-11-312	.125"	3"OD	12'	7"	1/2"	7"	3/4x16x3	1.0	18#
RSA-11-314	.125"	3"OD	14'	7"	1/2"	7"	3/4x16x3	.7	20#
RSA-11-410	.125"	4"OD	10'	9 1/2"	3/4"	9 1/2"	3/4x16x3	4.1	21#
RSA-11-412	.125"	4"OD	12'	9 1/2"	3/4"	9 1/2"	3/4x16x3	3.2	24#
RSA-11-414	.125"	4"OD	14'	9 1/2"	3/4"	9 1/2"	3/4x16x3	2.3	28#
RSA-11-415	.125"	4"OD	15'	9 1/2"	3/4"	9 1/2"	3/4x16x3	1.9	30#
RSA-11-416	.125"	4"OD	16'	9 1/2"	3/4"	9 1/2"	3/4x16x3	1.5	32#
RSA-11-418	.125"	4"OD	18'	9 1/2"	3/4"	9 1/2"	3/4x24x3	.8	36#
RSA-11-420	.125"	4"OD	20'	9 1/2"	3/4"	9 1/2"	3/4x24x3	.1	40#
RSA-7-418	.188"	4"OD	18'	9 1/2"	3/4"	9 1/2"	3/4x24x3	4.8	46#
RSA-7-420	.188"	4"OD	20'	9 1/2"	3/4"	9 1/2"	3/4x24x3	3.9	53#
RSA-11-510	.125"	5"OD	10'	9 1/2"	3/4"	9 1/2"	3/4x16x3	4.2	33#
RSA-11-512	.125"	5"OD	12'	9 1/2"	3/4"	9 1/2"	3/4x16x3	5.6	38#
RSA-11-514	.125"	5"OD	14'	9 1/2"	3/4"	9 1/2"	3/4x16x3	4.2	43#
RSA-11-515	.125"	5"OD	15'	9 1/2"	3/4"	9 1/2"	3/4x16x3	3.8	45#
RSA-11-516	.125"	5"OD	16'	9 1/2"	3/4"	9 1/2"	3/4x16x3	3.1	48#
RSA-11-518	.125"	5"OD	18'	9 1/2"	3/4"	9 1/2"	3/4x24x3	2.2	53#
RSA-11-520	.125"	5"OD	20'	9 1/2"	3/4"	9 1/2"	3/4x24x3	1.3	58#
RSA-7-518	.188"	5"OD	18'	9 1/2"	3/4"	9 1/2"	3/4x24x3	4.2	67#
RSA-7-520	.188"	5"OD	20'	9 1/2"	3/4"	9 1/2"	3/4x24x3	3.8	73#
RSA-7-522	.188"	5"OD	22'	9 1/2"	3/4"	9 1/2"	3/4x24x3	3.2	79#
RSA-7-524	.188"	5"OD	24'	9 1/2"	3/4"	9 1/2"	3/4x24x3	3.7	85#

CONSTRUCTION

Round straight aluminum poles are fabricated from 6063 extruded tubing, heat treated to produce a T6 temper. The anchor base shall be cast from a 356 alloy aluminum, heat treated to a T6 condition. The base telescopes the pole shaft and is circumferentially welded top and bottom. Anchor bolts are fabricated from hot rolled steel bar with a minimum yield strength of 50,000 psi. Anchor bolts are hot dip galvanized in accordance to ASTM-A-153.

OPTIONS

- AT – 2-3/8" O.D. x 5" long tenon
- BT – 2-7/8" O.D. x 5" long tenon
- CT – 3" O.D. x 5" long tenon
- BC – Two piece square base cover
- DR – Duplex receptacle
- PR – Provisions for receptacle

FINISH

- BZ – Bronze Paint
- BZA – Bronze Anodized
- BK – Black Paint
- BKA – Black Anodized
- GN – Green Paint
- WT – White Paint
- CLA – Clear Anodized

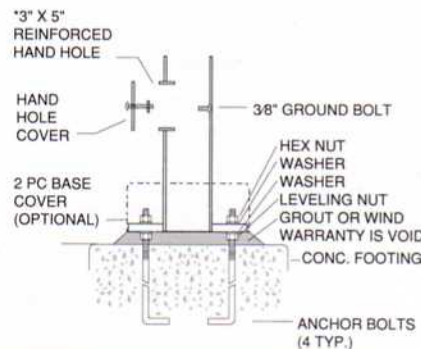
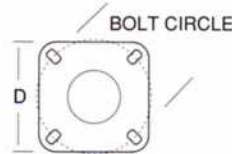
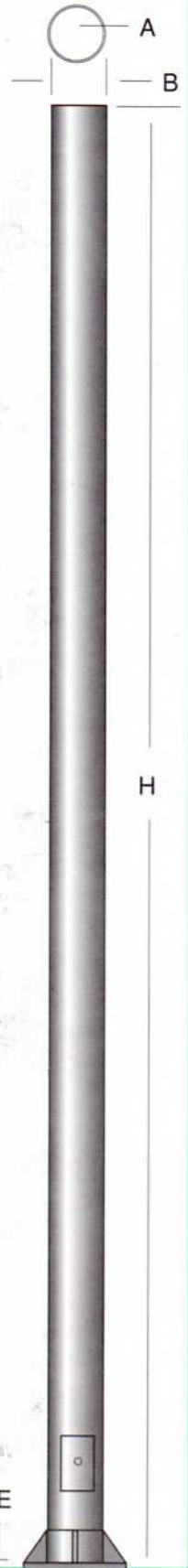

ORDERING EXAMPLE

CATALOG NO. **RSA-11 - 412 - BC - DR - WT**
 OPTIONS
 FINISH

*Hand hole on 3" and poles below 16' may not be reinforced.